



youlan

Veterinary Dentistry

Better Care For Oral Health

www.ylvet.com | Youlan Medical

Shenzhen Youlan Medical Technology Co.,LTD.



Company Overview

youlan

www.ylvet.com | Youlan Medical

Shenzhen Youlan Medical Technology Co., Ltd is a high-tech enterprise specializing in the R&D, production, and sales of veterinary medical equipment and consumables.

Founded in early 2016, Youlan Medical focuses on five major product lines for veterinary medical equipment: **veterinary dental devices and consumables, laser systems, imaging products, PMLS, and IVD products.** We offer a comprehensive solution for animal dental care, including our self-owned brand veterinary dental units, surgical instruments, dental imaging systems, and laser systems.

Youlan Medical is committed to becoming the leading supplier of veterinary medical equipment and consumables, contributing to the health and well-being of both animals and humans.



Contents

www.ylvvet.com | Youlan Medical

youlan

01 ■ Veterinary Dental Unit 04

02 ■ Veterinary Dental Imaging system 09

03 ■ Veterinary Dental All In One Workstation 19

04 ■ Veterinary Dental Kits 24

Veterinary Dental Series

Better Care For Oral Health



FC Series

FC Series VET dental workstation can be used as a comprehensive dental working platform for tooth polishing, light curing, restoration, cutting and root canal treatment. It can also be used for animal tooth beauty, tooth removal, oral tumor cutting etc., bringing more help to animal welfare, It can also improve the veterinarian's handling of animal oral problems more efficiently.

> Multifunctional dental equipment

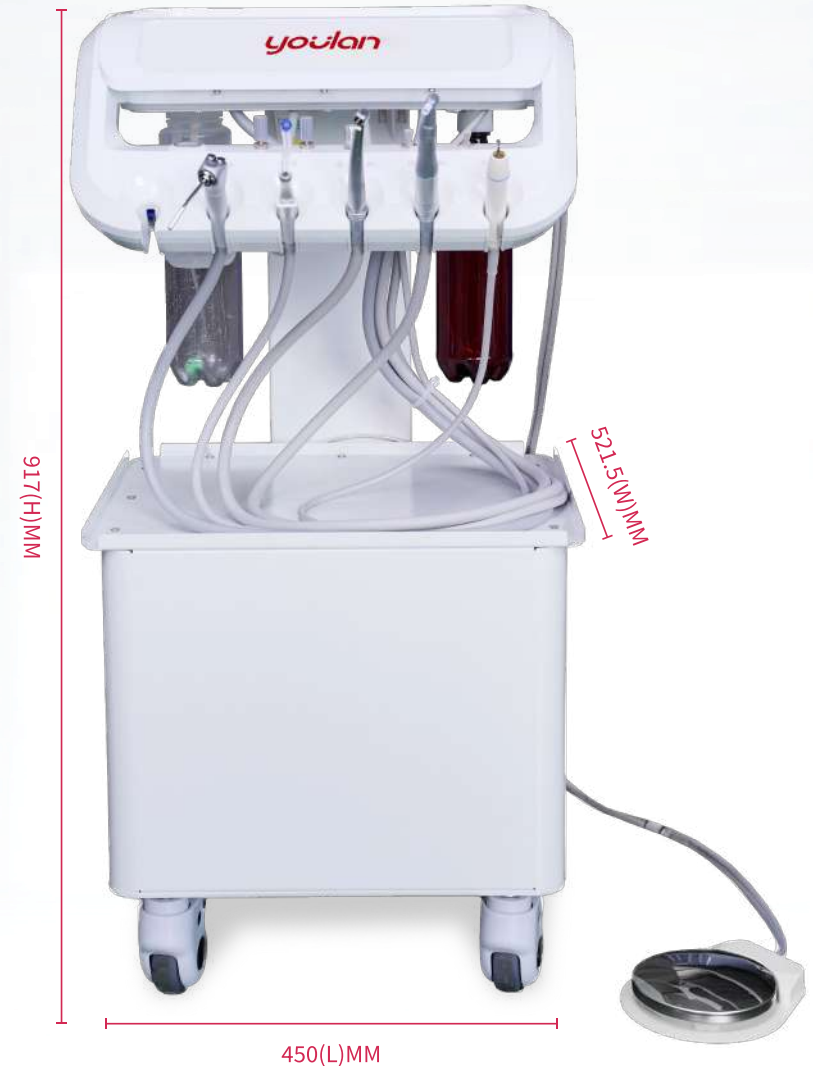
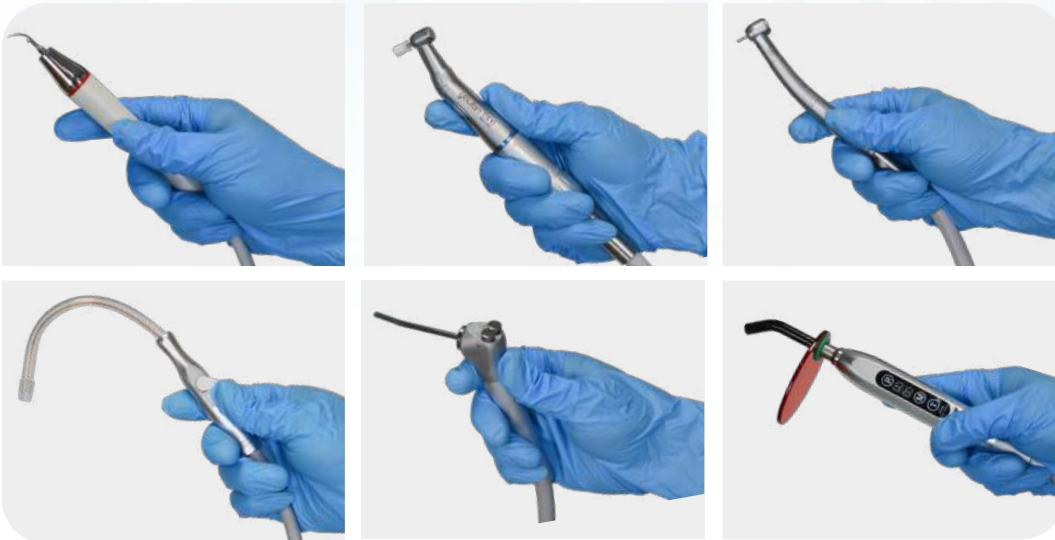

Design for animal

Comprehensive & professional

FC Series

Technical Parameters

Specification	FC6-Vet	FC5-Vet	FC4-Vet
Compressor	Oil-Free	Oil-Free	Oil-Free
Power	2.6-2.9A;220/230v; 50/60HZ; 110V(Optional)	2.6-2.9A;220/230v; 50/60HZ; 110V(Optional)	2.6-2.9A;220/230v; 50/60HZ; 110V(Optional)
Out Put Pressure	0.45~0.5MPa	0.45~0.5MPa	0.45~0.5MPa
Gas tank	8L	8L	8L
Sound Level	Less than 60dB	Less than 60dB	Less than 60dB
High Speed Handpiece	300000-340000rpm; Four-point spray; LED light	300000-340000rpm; Four-point spray; LED light	300000-340000rpm; Four-point spray; LED light
Low Speed Handpiece	External water	External water	External water
Low Speed	External water supply	External water supply	External water supply
Motor	Suitable for angle and straight external handpieces	Suitable for angle and straight external handpieces	Suitable for angle and straight external handpieces
Ultrasonic Scaler	With white LED light 28kHz±3kHz 5 scaler tips	With white LED light 28kHz±3kHz 5 scaler tips	With white LED light 28kHz±3kHz 5 scaler tips
Suction handpiece	High volume suction system	High volume suction system	--
LED Light curing unit	Wireless; Wavelength:420-480nm; Depth of cure:3mm/10s;	--	--
Dimension	L*W*H:45 cm * 52 cm * 92 cm		
Weight	About 60kg (Net Weight 45kg)		



Better care for animal 🦷

Product info.

Parameter	FC6-Vet	FC5-Vet	FC4-Vet
Compressor	○	○	○
High Speed Handpiece1	○	○	○
High Speed Handpiece2	optional	--	--
Low Speed Handpiece	○	○	○
Scaler Handpiece	○	○	○
3 Way Syringe	○	○	○
Suction Handpiece	○	○	--
LED Light Curing Unit	○	--	--

(○:YES; --:NO)

ProDx Series

ProDx Series workstation can be used as a comprehensive dental work platform for tooth polishing, restoration, cutting and root canal treatment. It can also be used for animal tooth beauty, tooth removal, oral tumor cutting, etc., bringing more help to animal welfare, It can also improve the veterinarian's handling of animal oral problems more efficiently.



Smart

Area size 44*36.5cm, saving space; Height is adjustable, between 90cm and 105cm, suitable for the work requirements of veterinarians.



High efficiency and low noise

High-quality oil-free air compressor, low noise. Water pressure flow can be controlled simply and efficiently

> Multifunctional dental handpiece

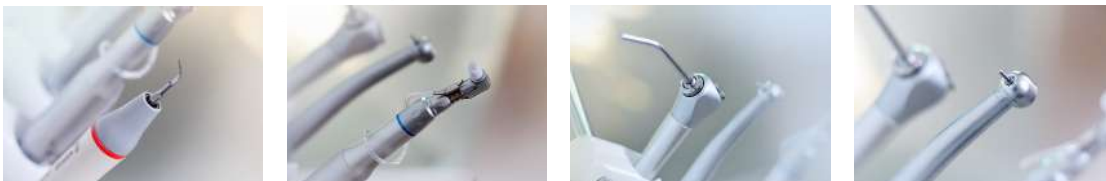

Smart & Efficient

Design for animal



ProDx Series

> Super quiet work mode

Less than 40dB;

Reduce the disturbance of noise to the veterinarian's work;

Improve the efficiency of veterinary dental procedures;



Product info

Specification	Prodx20	Prodx5	Prodx4
Compressor	Oil-Free (Oil optional)		
Power	2.6-2.9A	220/230v	50/60HZ 110V(Optional)
Out Put Pressure	0.45~0.5MPa		
Gas tank	20L	8L	8L
Sound Level	Less than 60dB		
High Speed Handpiece	300000-340000rpm	Four-point spray	LED light
Low Speed Handpiece	Internal water supply		
Low Speed Motor	Internal water supply		
Ultrasonic Scaler	With white LED light	28kHz±3kHz	5 scaler tips
Suction handpiece	High volume suction system	High volume suction system	--
LED Light curing unit	Wireless; Wavelength:420-480nm; Depth ofcure:3mm/10s;	--	--
Dimension (mm)	450*495* (790-1160)	365*440* (760-1160)	
Weight(KG)	40 (oil free) 45 (with oil)	40 (oil free) 43 (with oil)	40 (oil free) 41.5 (with oil)

Better care for animal 🐾

Parameter	Prodx20	Prodx5	Prodx4
Air tank	20L	8L	8L
Compressor (oil free)	○	○	○
Compressor (with oil)	Optional		
High Speed Handpiece 1	○	○	○
Low Speed Handpiece	○	○	○
Scaler Handpiece	○	○	○
3 Way Syringe	○	○	○
Suction Handpiece	○	○	--
LED Light Curing Unit	○	--	--

(○:YES; --:NO)

Veterinary Dental Imaging System



Veterinary Dental X Ray Series

www.ylvet.com | Youlan Medical



Youlan Veterinary Portable Dental X-ray Digital Imaging Solution

youlan

(YL-R2VET)

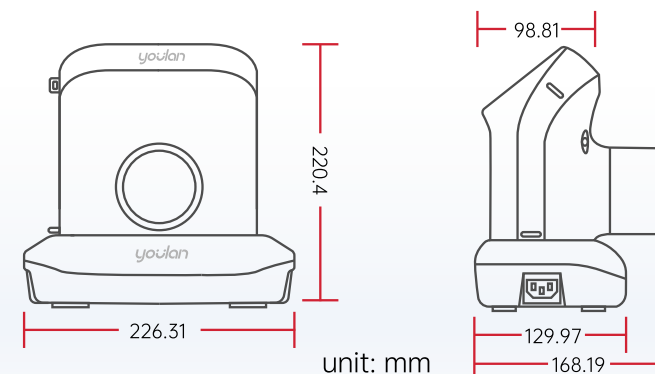

www.ylvet.com

Youlan Medical

Adjustable KV and mA for Versatile Applications

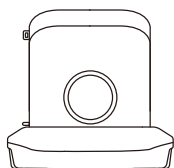

Stable Voltage & Current Output

65Kv & 2.6mA deliver higher power for deeper tooth penetration and clearer imaging.

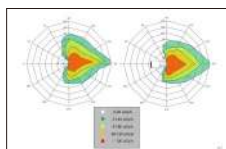

Ultra-low radiation dose

Giving doctors the highest level of safety protection



Pet-specific dental software

Optional dental software for dogs, cats and other pets

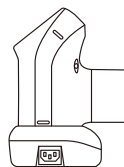

Continuous Live Charging

Patented docking system maintains permanent full-power standby.

Parameter information

Parameter Name	Parameter Index
Focal Spot	0.4 mm
Tube Voltage	65 kV
Tube Current	2.6 mA
Exposure Time Range	0.01–2 sec
Inherent Filtration	0.8 mm Al
Additional Filtration	1.0 mm Al
Source-to-Skin Distance (SSD)	200 mm
X-ray Field Diameter	Ø60 mm
Power Input	22.2V DC
Weight	2.1 kg

Mobile and Wall mount X-ray



Precision Imaging

0.8mm focal spot ensures clear imaging.



Reliable and stable

Self regulating with gas springs

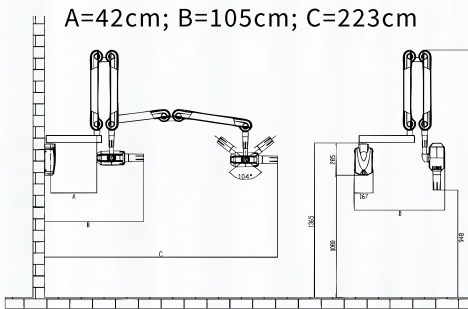

Fashion design and flexibility

Integrated design with self-balancing system

Flexible arm extension



Specification

Specification	Mobile/ Wall mount
Power Voltage	AC 230V \pm 10%
Frequency	50/60Hz
Ultimate Capacity	900VA
Focal spot	0.8mm
Rated High-Voltage	70KV \pm 10%
Tube-Head Current	7mA \pm 20%
Exposure Time	0.06~2.00s
Inherent Filtration	\geq 2.1mmAl
Radiation Leakage	<0.07mGy/h

Safety and more health

high frequency X-ray generator and canon X ray tube significantly reduces radiation dosage compared to traditional X-ray units.

Control panel system

Wire control or wireless control(optional)

The control panel can be selected for pet types and different teeth



Veterinary Oral Sensor

• Shenzhen Youlan Medical Technology Co.,LTD. •

www.ylvet.com | Youlan Medical

- ♥ Applicable to oral structures of felines and canines.
- ♥ Applicable to exotic pets such as turtles, rabbits, birds, etc.
- ♥ Applicable to orthopedic photography of companion animals, etc.



Veterinary Oral Digital Sensor

> Size 1/2

- CMOS detector technology
- Low-dose clinical imaging
- High resolution
- Wide dynamic range
- Size1 suitable for small size Canine and Feline
- Size2 suitable for normal size Canine and Feline
- Slim, rounded corner and smooth edge
- Direct USB connectivity
- AED trigger, fast and easy workflow
- Durable material and components
- Friendly software user interface

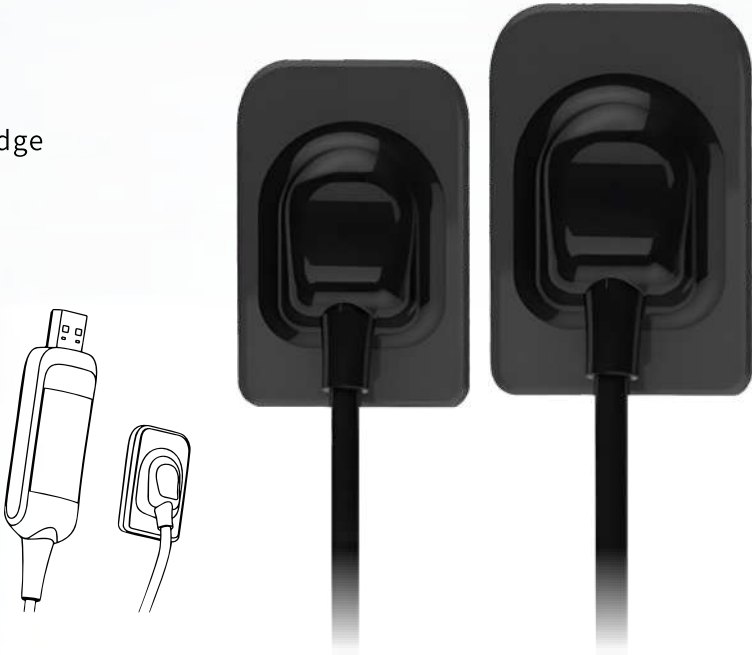
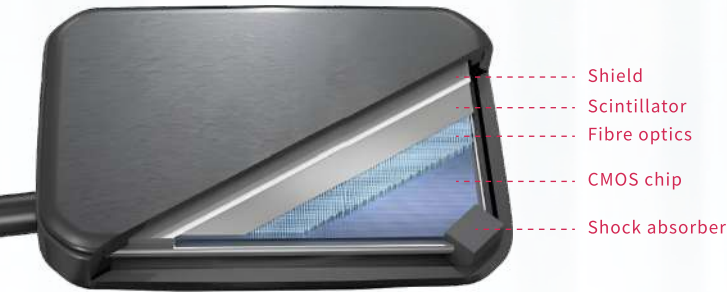

Dimensions

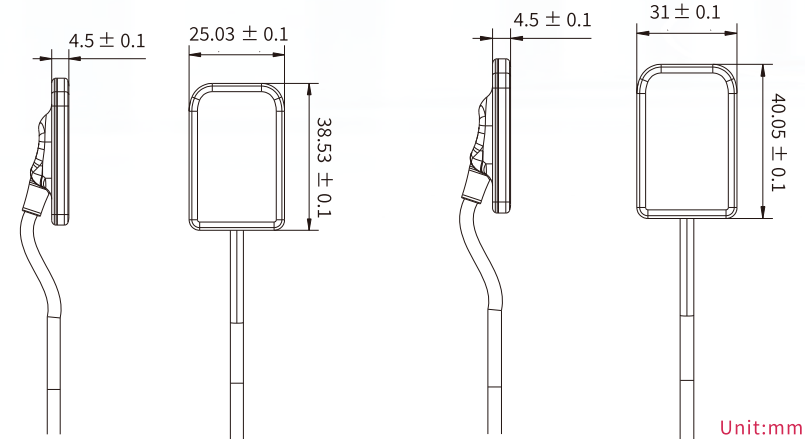

Product info

Parameter	Size1	Size2
Detector Technology	CMOS	CMOS
Scintillator	Directly deposited CSI:TI	Directly deposited CSI:TI
Pixel Pitch (μm)	20	20
Pixel Matrix	1.5M(1000*1500)	2.34M(1300*1800)
Active Area (mm²)	20x 30	26x 36
AD Conversion (bit)	16	16
Exposure Mode	Smart AED	Smart AED
X-ray Exposure (s)	Max. 5s	Max. 5s
X-ray Energy Range (kV)	55~100kV	55~100kV
Dimensions (mm3)	25.0 × 38.5 × 4.5	31.0 × 45.0 × 4.5
Length of cable (m)	3m	
Radiation dose	≥ 50Gy	
Ingress Protection	IP68	
Additional	Support TAWIN Protocol	
Operation System	Windows7 and above,32/64bit	

> Size 4

• Streamlined Workflow Integration

Easily adapts to veterinary practices, ensuring a smooth setup and operation process.

• Wide Dynamic Range

Ensures excellent detail capture, even in challenging exposure conditions.

• High Resolution – 20 lp/mm

Provides sharp and precise imaging for accurate diagnostics.

• Optimized for Large Animals

Perfect for large canines, as well as wildlife like lions and tigers.

• Intuitive User Interface

Simplified controls and settings enhance ease of use for all operators.

• Maximized Efficiency

Accelerates diagnostics, saving time and boosting overall productivity.

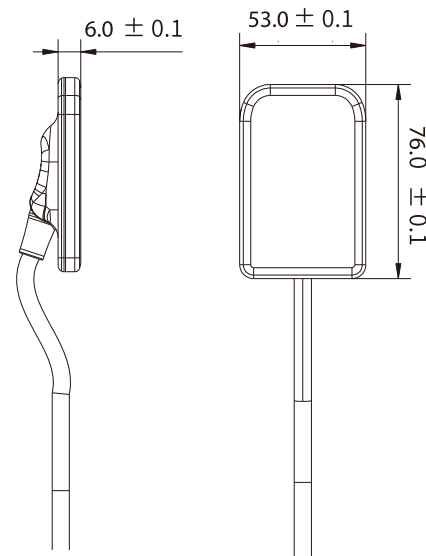

Veterinary dental software

- Lower dose, Lower cost
- More convenient application

Higher image quality

- Professional vet dental analysis software
- With Canine and Feline and other different animal tooth distribution
- One-click diagnosis function
- Continuous exposure screen
- Great picture edit function



RIOScan CR

Shenzhen Youlan Medical Technology Co.,LTD.

www.ylvvet.com | Youlan Medical





Leading Technology, Ultimate Clarity

- ♥ Applicable to oral structures of felines and canines.
- ♥ Applicable to exotic pets such as turtles, rabbits, birds, etc.
- ♥ Applicable to orthopedic photography of companion animals, etc.



Fast and intuitive workflow

RioScan offers various functions to minimize work time.

-  **5 second scan time (HS Mode)**
-  **Auto erasing**
-  **Automatic plate detection**
Plate insertion and correct plate side is detected for image reading.
-  **Preview function**
Users can check the images through the touch screen whether they are properly attained.
-  **QuickScan mode**
Images can be scanned and stored in the internal memory while network connection has dropped.

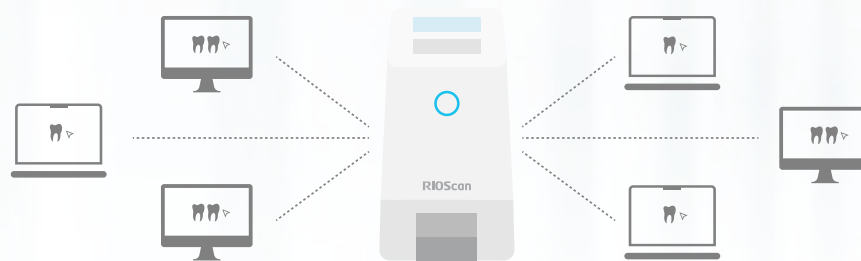

> Multiple access and sharing in your clinic

Users can place RioScan at any small space in their clinics, such as chair side, worktable or x-ray room, for convenient scanning.

Ethernet connection enables users to view the images in every PC in the clinic.

> Convenient image management

RIOView software provides convenient features such as image management, image measurement, multi-view and FMX (Full Mouth X-ray) mode.

Users can also adjust image filters upon their preferences including sharpness, brightness and contrast.



7 Image plate storage box pad

* Removable and washable for hygienic purpose

RIOScan CR

- ♥ Applicable to oral structures of felines and canines.
- ♥ Applicable to exotic pets such as turtles, rabbits, birds, etc.
- ♥ Applicable to orthopedic photography of companion animals, etc.

LEADING TECHNOLOGY, ULTIMATE CLARITY

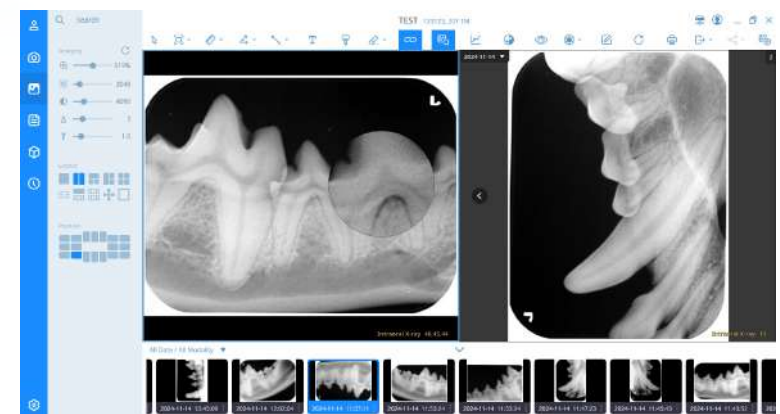

> For Chairside & Multi-share

Multi-access with Existing Ray Viewer



Doctor Consultation

SMARTDent¹⁾

Integration with Existing 3rd Party Viewer

TWAIN / RAY SDK
Bridge(PMS)
Gateway(PACS)

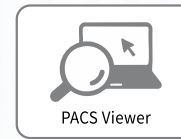

PACS Viewer



Workstation Viewer



Practice Management Software

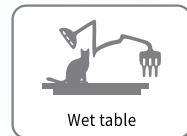

Wet table

Standalone
RIOView



> Network environment

- Support standalone and multiple network access
- Support 3rd party integration with TWAIN, RAY SDK, bridge and gateway.
- DICOM 3.0 compatible

> Operating environment

Operating system	Microsoft Windows 7(32bit / 64bit) Microsoft Windows 8(32bit / 64bit) Microsoft Windows 10(32bit / 64bit)
Processor	Intel i5 or higher
Screen resolution	1280 x 800 or higher
Ethernet	100Mbps fast ethernet

1) SMARTDent server(Ray Server) only operates under Windows 7 Professional

> Technical Data

Specifications RIOScan(Model: RPS500)

Item	Occlusal kit	Standard package
Image plate size	Size 0~ Size 3	Size 4
Resolution (Theoretical)	SHR 21 lp/mm HR 16 lp/mm HS 9 lp/mm	
Gray scale	14 bit	
Display	4.3" Touch screen	
Connection	Ethernet	
Dimension	170(W) × 260(H) × 278(D) mm	
Weight	Approx. 3.5 kg	
Power supply	100-240 V~, 1.5 A, 50-60 Hz, (24 VDC Adapter, 2.5 A)	

Image Plate Sizes

22x35 mm 0.87x1.38"	24x40 mm 0.94x1.57"	31 x41 mm 1.22x1.61"	27x54 mm 1.06x2.13"	57x76 mm 2.24x2.99"

Operation Conditions

- Temperature : 10~35 °C
- Humidity : 20~80 % RH



Veterinary Dental All-In-One Workstation

DTW-100VET

Integrated solution of veterinary dentistry

DT -100VET

DTP -100VET

DTW -100VET



DTW-100VET

Integrated solution of
veterinary dentistry

Functions

- 
Comprehensive application
scaling, radiography and treatment.
- 
Convenient and efficient
Intelligent combination of instrument trays, wall-mounted (or portable) dental X-Ray and shadow free LED lamp, Easy to use.
- 
Saving space
set dental work station, dental DR imaging system, oral shadow free LED light multifunctional in one, 1+1+1>3.
- 
Animal welfare
Advanced veterinary dental treatment workstation can bring more welfare to animal's oral cavity.
- 
Multiple modes
Can be equipped with a veterinary anesthesia machine and monitor, endoscope, etc.
- 
Improve treatment
Quiet and comfortable operating environment and multi-function advanced veterinary dental treatment workstation can quickly improve the diagnosis and treatment of animal's oral cavity.

Better care for animal 

Parameter

Item Name	Parameter
Power supply	AC 220V/50Hz
Noise	≤40db
Tank capacity	15L
Instrument tray	Upper pendant, with an air braking system
X-Ray generator	Wall mount 7mA;70KV
Intraoral sensor	Size1:25.0 mm *38.5 mm *4.5mm Size2:31.0 mm *45.0 mm *4.5 mm (optional) Size4:53.0mm *76.0mm *6.0mm (optional)
Shadow free oral LED light	LUX:7000-45000 Color temperature:5000-6000
Dimensions	L:60--160cm 2:80--300cm H:200cm
Weight	DT-100VET:80Kg, DTW- 100VET:110Kg, DTP- 100VET:100Kg

Veterinary Dental All-In-One Workstation DTW-100VET

Youlan Medical DT-100VET/DTW-100VET/DTP-100VET is a multi-functional veterinary dental comprehensive treatment station which integrates veterinary dental cleaning, polishing, digital imaging, tooth filling and root canal therapy.



HD Display

Higher resolution, Windows system, built-in veterinary Intraoral Imaging acquisition software, quickly acquires, processes, and manages high quality, diagnostic images. Customizable software features and tools. Reserved position for an optional endoscope.



Dental instrument tray

Upper Pendant instrument tray with a precision air braking system. Adjustable height, accommodate the variety of veterinary work situations. Multi-angle adjustment. Integrated 3-Way Syringe, high-speed & low-speed handpiece, Ultrasonic Scaler, suction. Dual- high handpiece hangers, improve efficiency of dental treatment.



Handpiece features

Low-speed handpiece equipped with high quality motors. High-speed handpiece with high brightness LED light, 4-point water hole. Ultrasonic scaler with high brightness LED light, different cleaning tips equipped. Reserved one handpiece hanger position for optional extra handpiece choice.



Dental Workstation main structure system

Flexible for different options (dental X-Ray /veterinary anesthesia machine, etc.) The support arm of the equipment can be assembled in a flexible form, suitable for different veterinarian working habits and to achieve optimal ergonomics.



Shadow free oral therapy lamp

Especially suitable for oral therapy
Touch control
Multi-gear light intensity



Dental X-Ray

Wall mount X-Ray machine integrated. Hi-frequency DC technology, shorter exposure times, reduced dose. 0.4 mm focal spot provides higher resolution images. Long reach arm with frictionless joints and a precision braking system, easy to position.



Main container

Ultra-quiet mode & anti-shaking mode
Stable center of gravity with anti-tipping function
Manual drain & exhaust system

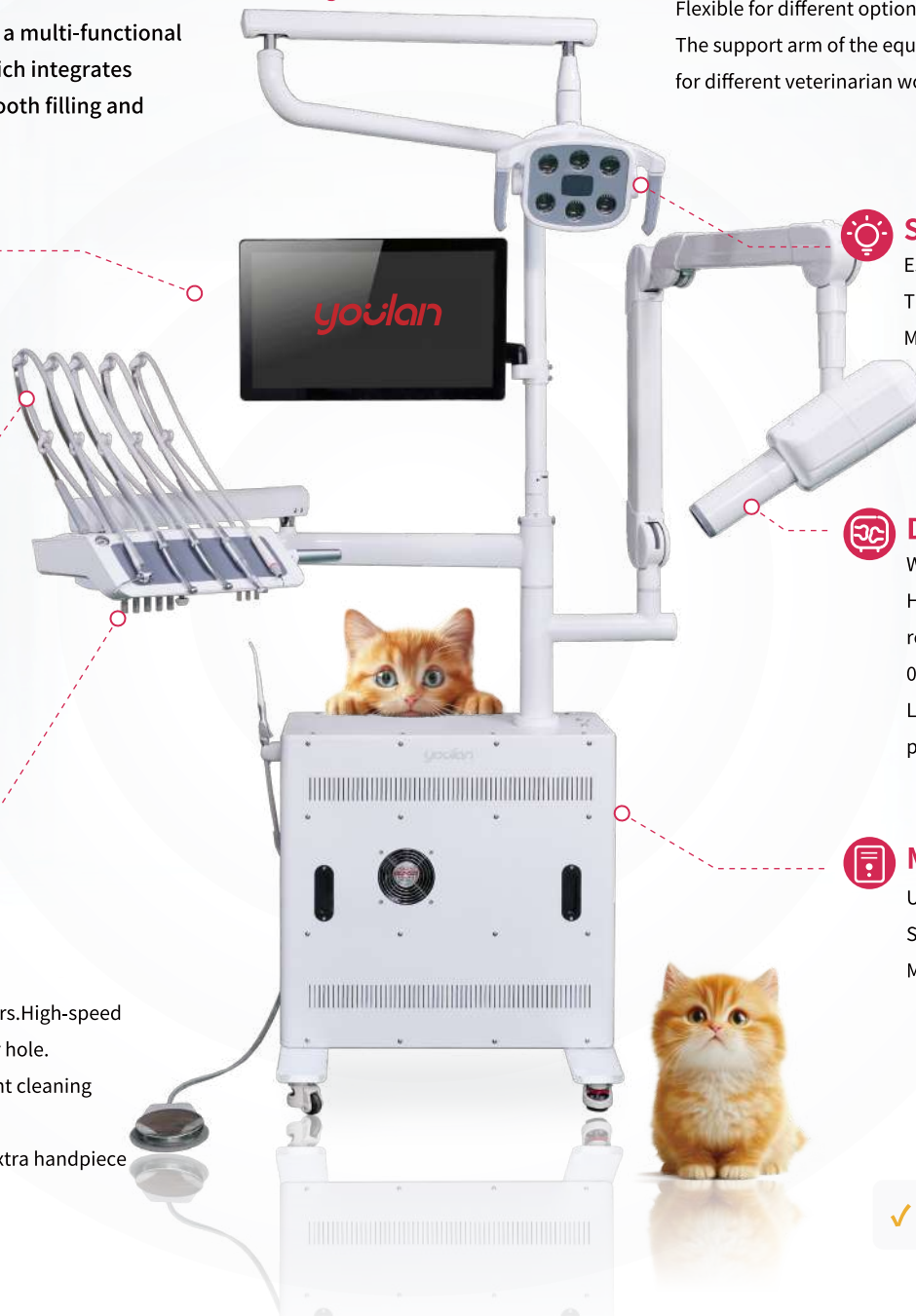

OPTIONAL

✓ Monitor

✓ Anesthesia machine

> Product view



Veterinary Dental
All-In-One Workstation

DTW-100VET

OPTIONAL

YM10-VET

Monitor optional

Portable, reliable, and safe



**Anesthesia
machine optional**

Tabletop animal anesthesia
machine, simple and safe

YM30-VET



Veterinary Dental All-In-One Workstation

DTW-100VET

- ♥ Dental digital imaging system
- ♥ Multi-function dental workstation
- ♥ Shadow free LED lamp for oral therapy
- ♥ Safe and stable veterinary anesthesia machine
- ♥ Veterinary multi-function monitor

Configuration options

● STANDARD ○ OPTIONAL --- NONE

ConfigurationItem	DT-100VET	DTW-100VET	DTP-100VET
Integrated case	●	●	●
Ultra-quiet compressor	●	●	●
Gastankwith train function	●	●	●
Main switch for water, gas and electricity	●	●	●
Shadow free oral LED light	●	●	●
HD Display	---	●	●
Pendant instrument tray	●	●	●
Assistant rack(stainless steel tray)	●	●	●
Water/gas pipe (Acid/alkali/oilresistance)	●	●	●
Pedal	●	●	●
Suction3-way syringe	●	●	●
Low-speed handpiece	●	●	●
High-speed handpiece1	●	●	●

Better care for animal 🦷

ConfigurationItem	DT -100VET	DTW-100VET	DTP-100VET
High-speed handpiece2	○	○	○
Ultrasonic scaler	●	●	●
Wireless light curing	●	●	●
Distilled water bottle	●	●	●
Antiseptic bottle	●	●	●
Waste liquid bottle	●	●	●
Portable oral X-Ray	---	---	●
Wall-mountX-Ray	---	●	---
Intraoral sensor Size1	---	●	●
Intraoral sensor Size2	---	○	○
Tabletop anesthesia YM30VET	○	---	---
Veterinary monitor YM10VET	○	○	○

Veterinary Dental Kits

• Shenzhen Youlan Medical Technology Co.,LTD. •



> Stubby handle elevator instrument kits



Item Name	Parameter	Item Name	Parameter
YLDK001	Winged Elevator with Stubby Handle1mm	YLDK009	Minesota Retractor
YLDK002	Winged Elevator with Stubby Handle2mm	YLDK010	Subgingival Curette
YLDK003	Winged Elevator with Stubby Handle3mm	YL DK011	Jaquette Suprangingiva Scaler
YLDK004	Winged Elevator with Stubby Handle4mm	YLDK012	Sickle Scaler
YLDK005	Winged Elevator with Stubby Handle5mm	YLDK013	Explorer and Measuring Probe
YLDK006	Winged Elevator with Stubby Handle6mm	YLDK014	Extraction Forceps
YLDK007	Straight Root Tip Pick	YLDK015	Double Ended Peristial Elevator
YLDK008	Tartar Removing Forceps		

> Feline instrument kits



Item Name	Parameter
YLFD001	Stubby Handle Elevator,STR Tip 1mm
YLFD002	Stubby Handle Elevator,STR Tip 2mm
YLFD003	Explorer and Measuring Probe,Cats/ Small Dogs
YLFD004	Double Ended Periosteal Elevator,Cats/ Small Dogs
YLFD005	Resorptive Lesion Probe
YLFD006	Sickle Scaler,Cats/Small Dogs
YLFD007	Curette,Cats/Small Dogs
YLFD008	Extraction Forceps,Small,Cats.Small Dogs



> Stubby handle elevator kits



Item Name	Parameter
YLDK001	Winged Elevator with Stubby Handle 1 mm
YLDK002	Winged Elevator with Stubby Handle 2 mm
YLDK003	Winged Elevator with Stubby Handle 3 mm
YLDK004	Winged Elevator with Stubby Handle 4 mm
YLDK005	Winged Elevator with Stubby Handle 5 mm
YLDK006	Winged Elevator with Stubby Handle 6 mm

> Milk dental kits



Item Name	Parameter
YL015	Small Dog&Cat Right Angle Extraction Forceps, 12.5cm
YL016	Curved Deciduous Elevators - Small(2mm)
YL017	Curved Deciduous Elevators - Medium(3mm)
YL018	Curved Deciduous Elevators - Large(4mm)
YL019	Molt Periosteal Elevators - No.9

> Table Top Mouth Gag (Rabbit/Rodent)

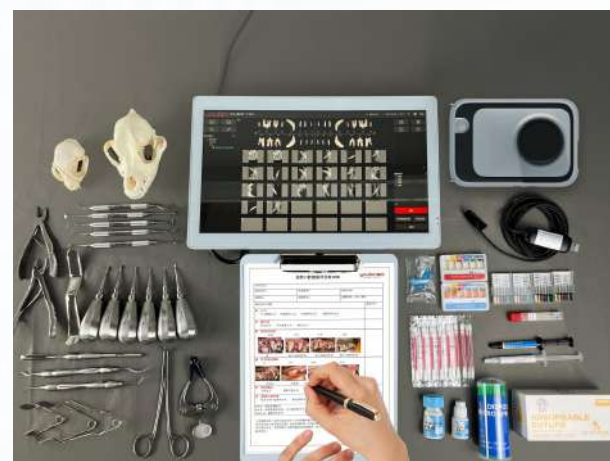

> Rabbit and rodent kits



Item Name	Parameter
YLRD001	Incisor Luxator
YLRD002	Molar Luxator
YLRD003	Spatula
YLRD004	Cheek Dilator Small
YLRD005	Cheek Dilator Large
YLRD006	Wire Mouth Gag
YLRD007	Rodent Mouth Gag
YLRD008	Cheek Teeth Extraction Forcep





youlan

Enjoy Health • Enjoy life

www.ylvet.com | Youlan Medical

Shenzhen Youlan Medical Technology Co.,LTD.

Address: 516, Building 4, Baoyunda Logistics Center, Fuhua Community,
Xixiang Street, Bao'an District, Shenzhen, Guangdong Province, China

Tel/WhatsApp: **+0086 188-2019-3720**

Email: sales@ylvet.com



 Facebook



 LinkedIn



 Instagram